



kate

reality



## 1048 Nubeena Road PREMAYDENA TAS

2 2 4

Beautiful farmhouse lifestyle property with a solid two bedroom home on 2.91 hectares of great pasture with lots of useful outbuildings. The property has good waterholes and a large lockup shed/workshop and attached carport. Plenty of room for fruit trees and vegetables for the house or if you like, plant a boutique crop to sell. In the past a large goat herd was successfully kept. The pasture is quick growing and lush with an excellent rainfall.

This house has a wonderful feel and is comfortable and cosy. The bathroom is beautiful and has a roll top bath and ample cupboards. Light airy and spacious master bedroom has a huge built in wardrobe and french doors onto the verandah, which surrounds the house. Polished floorboards and a wood fire with a lovely old mantelpiece gives a warm feeling to the main living room. Good storage and a double sink are features of the farmhouse style kitchen.

**Building Size** : 8 sqm  
**Land Size** : 29100 sqm  
**View** : <https://www.katestoreyrealty.com.au/sale/tas/hobart-southern/premaydena/residential/house/7162445>



**Kate Storey Realty**  
**(03) 6265 3000**

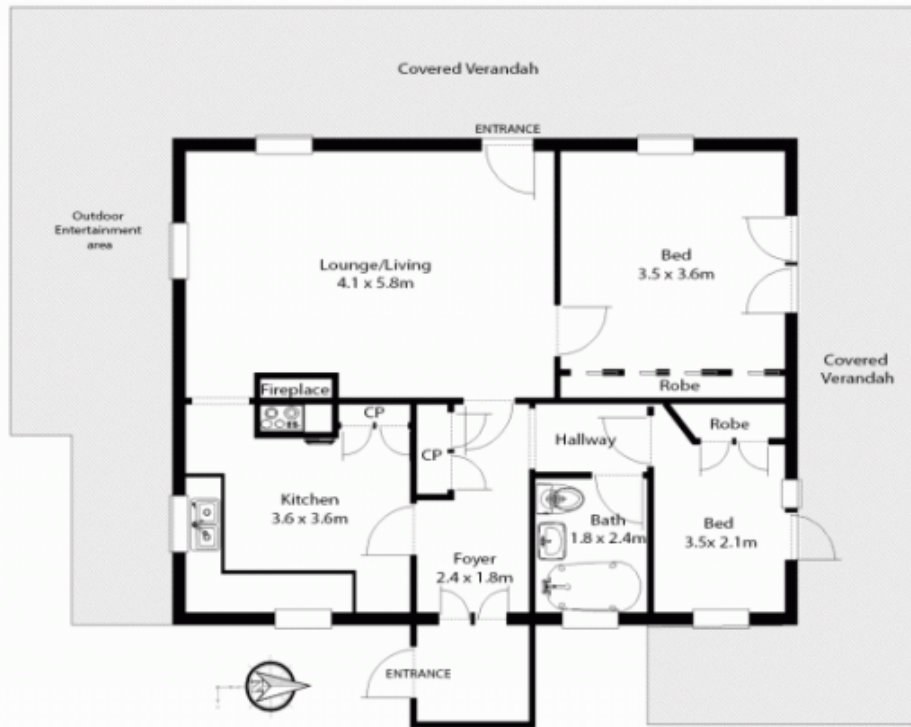

1048 Nubeena Road Premaydena Tasmania 7185  
 Approximate Internal space: 78 m<sup>2</sup>  
 Approximate Land Area: 29100m<sup>2</sup>

**Disclaimer:** This rendering and details are for informational purposes only. We make no warranties or representations, express or implied, as to the accuracy of this rendering. Independent detail verification is recommended.