



kate

reality



## 2/22 Parsonage Place Sorell TAS

2 1 1

This centrally and conveniently located two bedroom townhouse offers an exciting opportunity for those looking to start out or add to their investment portfolio.

Recently upgraded with double glazing throughout, once inside you become instantly aware of the comfort this addition has. With minimal heating you will be warm in the winter and cool in the summer, any road noise is silenced and they add a modern aesthetic to the home.

Entering through the secure front door, the ground floor includes lounge and kitchen, with under stair storage and a spacious bathroom/laundry.

Upstairs there are two good sized bedrooms, one offering views to local waterways and both with built in robes.

**Price** : \$ 440,000  
**Building Size** : 74 sqm  
**Land Size** : 143 sqm  
**View** : <https://www.katestoreyrealty.com.au/sale/tas/hobart-southern/sorell/residential/unit/7150089>



**Donna Wooley**  
03 6265 3000

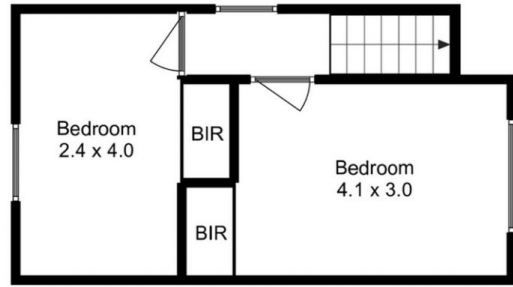

Upper Level

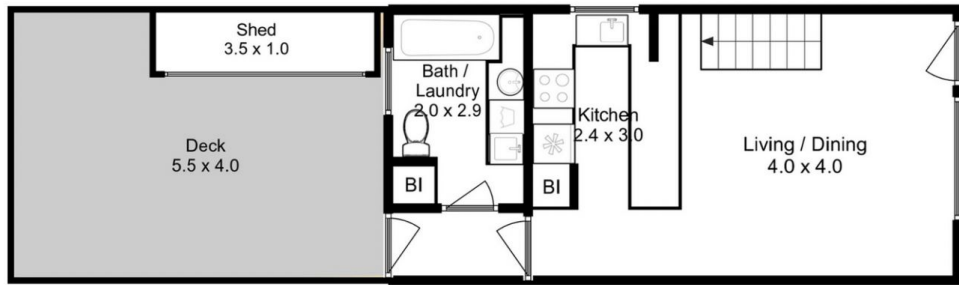
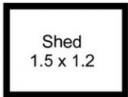

Lower Level



Approx. Floor Area : 72 sqm

All measurements are internal and approximate.  
 This plan is a sketch for illustration, not valuation.  
 Produced by Open2view.com