



kate

reality



7 Roaring Beach Road Nubeena TAS

3 1 2

Beautiful and spacious both inside and out with filtered views across Parsons Bay and out to Storm Bay. This lovely family home in a sunny position has 3 large bedrooms, two living areas, a formal dining and study. The bathroom consists of bath, shower and vanity with a separate toilet and laundry. The perfect layout to accommodate a growing family with connecting spaces yet privacy easily obtained with covered porch and large deck looking over yard to the water. Outside there are so many extras with a bare studio room, huge shed and double garage and an array of established fruit trees.

-Commanding position with extensive child friendly yard for outside play

-Wood heater to keep home warm and cosy

-Security screens on sliding doors provide airflow in Summer with peace of mind

Building Size : 192 sqm
Land Size : 0.4085 ha
View : <https://www.katestoreyrealty.com.au/sale/tas/hobart-southern/nubeena/residential/house/6520846>



Niahn Palmer
03 6253 6095

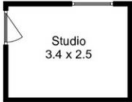
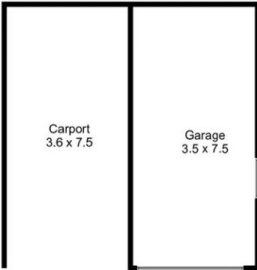
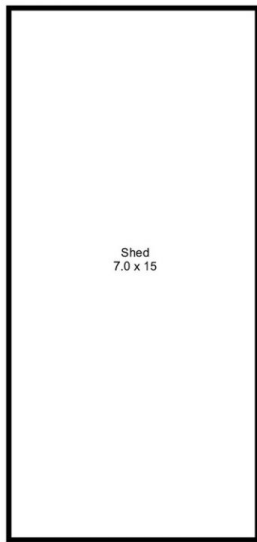

Total Approx. Floor Area : 192 sqm
 Total Approx. Outbuilding Area : 166 sqm

All measurements are internal and approximate.
 This plan is a sketch for illustration, not valuation.
 Produced by Open2view.com