



kate

reality



### 19/6 Dubs And Co Drive Sorell TAS

2  1  1 

Whether you are looking to nest or invest this modern low maintenance home in the popular and fast-growing town of Sorell is a must see!

The generous open plan kitchen and lounge area welcome you into the home. The 2 bedrooms are at separate ends of the home, and the modern bathroom is a good size. There is a study nook for those working from home or studying and a single garage with laundry and internal access. In addition, you have your own outdoor parking space and there is guest parking close by.

In a new home area this property offers you the convenience of an easy flat walk to the shopping precinct, doctors, pharmacies and much more. The Hobart airport and Hobart CBD are just a short commute.

**Price** : \$ 415,000  
**Building Size** : 93 sqm  
**Land Size** : 199 sqm  
**View** : <https://www.katestoreyrealty.com.au/sale/tas/hobart-southern/sorell/residential/unit/6284517>



**Niahn Palmer**  
03 6253 6095

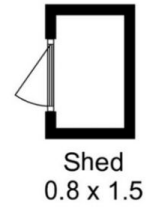
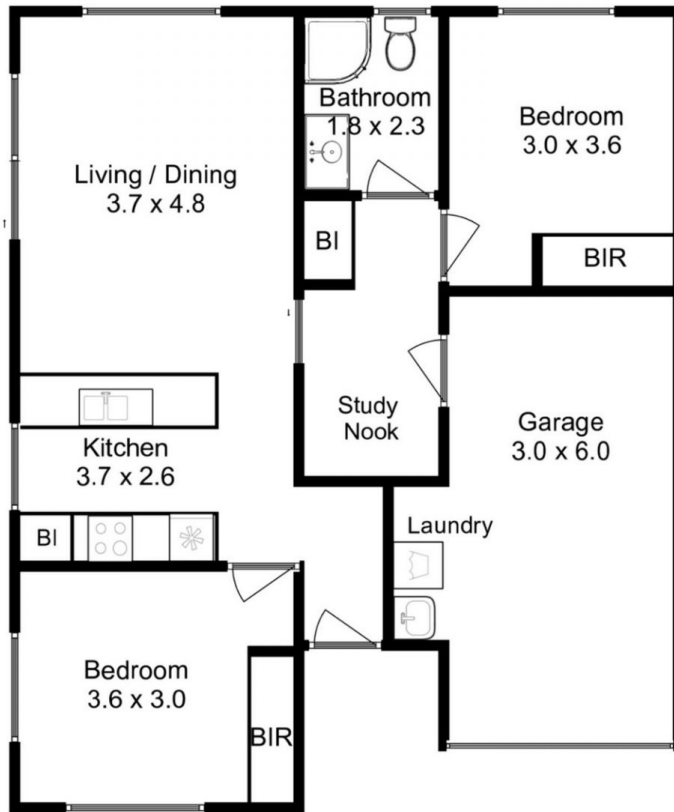

Floor area approx 93sqm  
(including garage)

All measurements are internal and approximate  
This plan is a sketch for illustration not valuation  
Produced by open2view.com for Kate Storey Realty