



kate

reality



38 Tasman Highway Sorell TAS

3  1  1 

If you are looking to purchase a first home or thinking about downsizing here is a well-designed and functional home within easy walking distance of the well serviced Sorell township.

There is much talk about the growing and fast moving pace of real estate in Greater Hobart and how it might be difficult for first home buyers or downsizers to find that right home at a reasonable price.

38 Tasman Highway just may be the answer.

Well positioned on a large parcel of land in a well-established neighbourhood, with local sports grounds nearby, is this neat and tidy home with plenty of room to move.

Price : \$ 435,500
Building Size : 93 sqm
Land Size : 751 sqm
View : <https://www.katestoreyrealty.com.au/sale/tas/hobart-southern/sorell/residential/house/5989701>



Donna Wooley
03 6265 3000

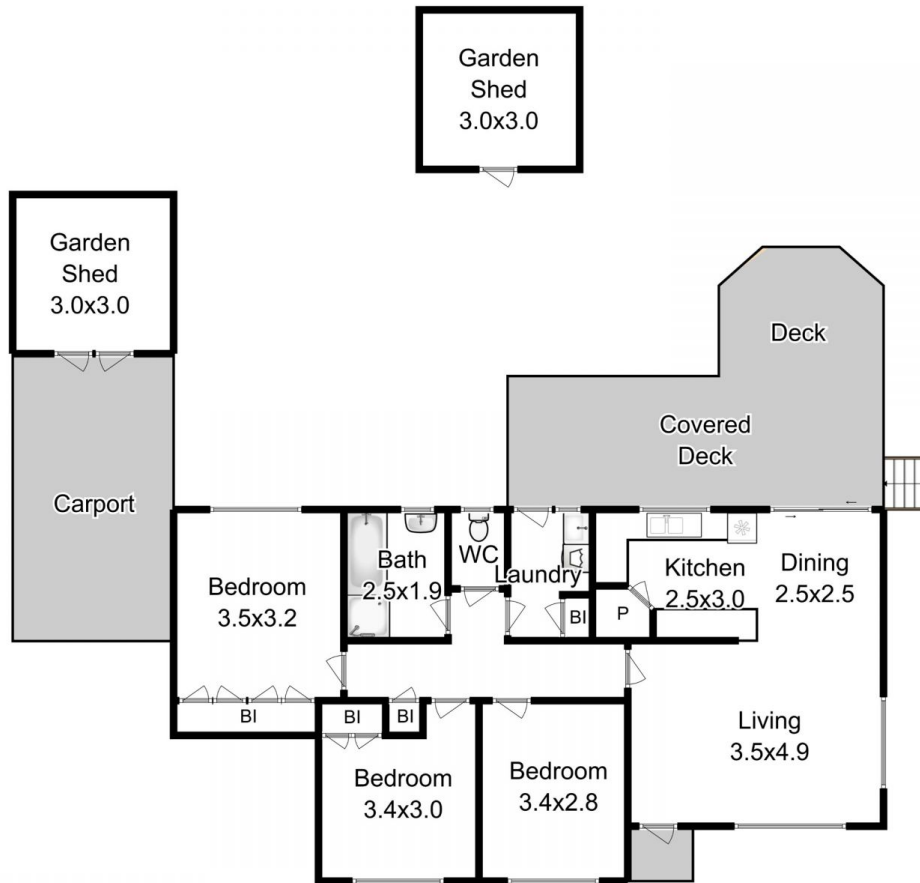

Total Approx. Floor Area : 90 sqm

All measurements are internal and approximate.
 This plan is a sketch for illustration, not valuation.
 Produced by Open2view.com for Kate Storey Realty.