



kate

reality



### 388 Sommers Bay Road Murdunna TAS

3 3 10

A world away, yet only approximately 1 hour from Hobart CBD. Adjoining the Waterfront Reserve nestled into a haven of natural native euphoria. The grand vista from your veranda holds the keys to peace and tranquillity. Here you can breathe the crisp fresh salt air, watch and hear the seas ebb and flow, the birds frolic, dolphins, seals, sea eagles glide the many moods of every changing enchanting sea that lays at your feet.

If all that is not yet enough for an ultimate "delight" to your senses, then step inside. Here you will easily become transfixed on the expanse of not only mesmerising water views, but here you enjoy views over King George Island, Smooth Island all the way to Mt Wellington. Sun set bliss.

Apart from being one of the most incredible parcels of waterfront in Tasmania this property offers a 2-3-bedroom

**Price** : \$ 988,000  
**Building Size** : 196 sqm  
**Land Size** : 3500 sqm  
**View** : <https://www.katestoreyrealty.com.au/sale/tas/hobart-southern/murdunna/residential/house/5818567>



**Kate Storey**  
03 6253 6095

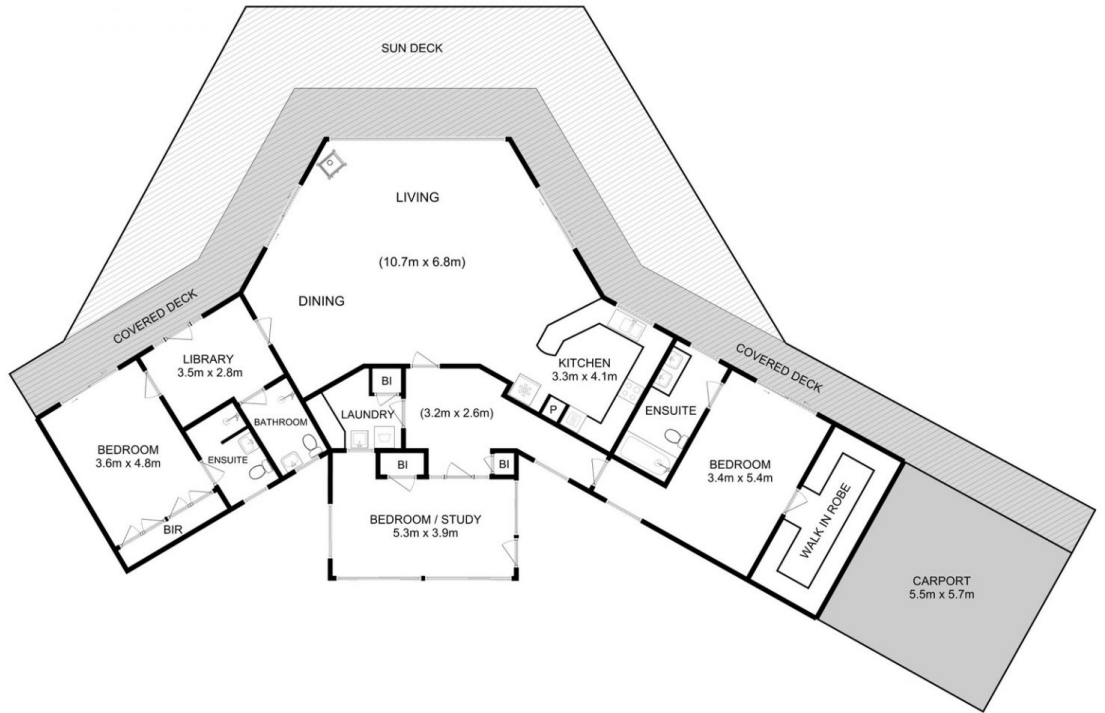
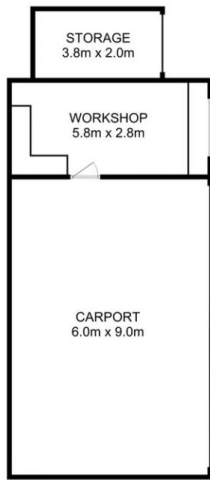

Total Approx. Floor Area : 196 sqm  
Total Approx. Outbuilding Area : 84 sqm

All measurements are internal and approximate.  
This plan is a sketch for illustration, not valuation.  
Produced by Open2view.com