



kate

reality



### 10 Sloping Main Drive Sloping Main TAS

3 1 2

Welcome to "The Shack" nestled only a few doors down from the beach. This cosy retreat offers 3 bedrooms and 1 bathroom, perfect for family getaways or year-round living.

Step inside to discover a spacious living area, ideal for relaxation or entertaining guests. With abundant natural light, every corner of "The Shack" feels warm and inviting.

Outside, you'll find a double garage and a convenient garden shed, providing ample storage space for your belongings. The large backyard is fully fenced providing peace of mind for your little ones and pets, offering endless opportunities for outdoor activities and gatherings.

Located just a short stroll away from the beautiful Sloping Main beach, this charming property offers the perfect blend of comfort and coastal living. Don't miss your chance to

**Price** : Offers Over \$465,000  
**Building Size** : 116 sqm  
**Land Size** : 617 sqm  
**View** : <http://www.katestoreyrealty.com.au/sale/tas/hobart-southern/sloping-main/residential/house/7978183>



**Kate Storey**  
03 6253 6095



**Chloe Wright**  
(03) 6265 3000

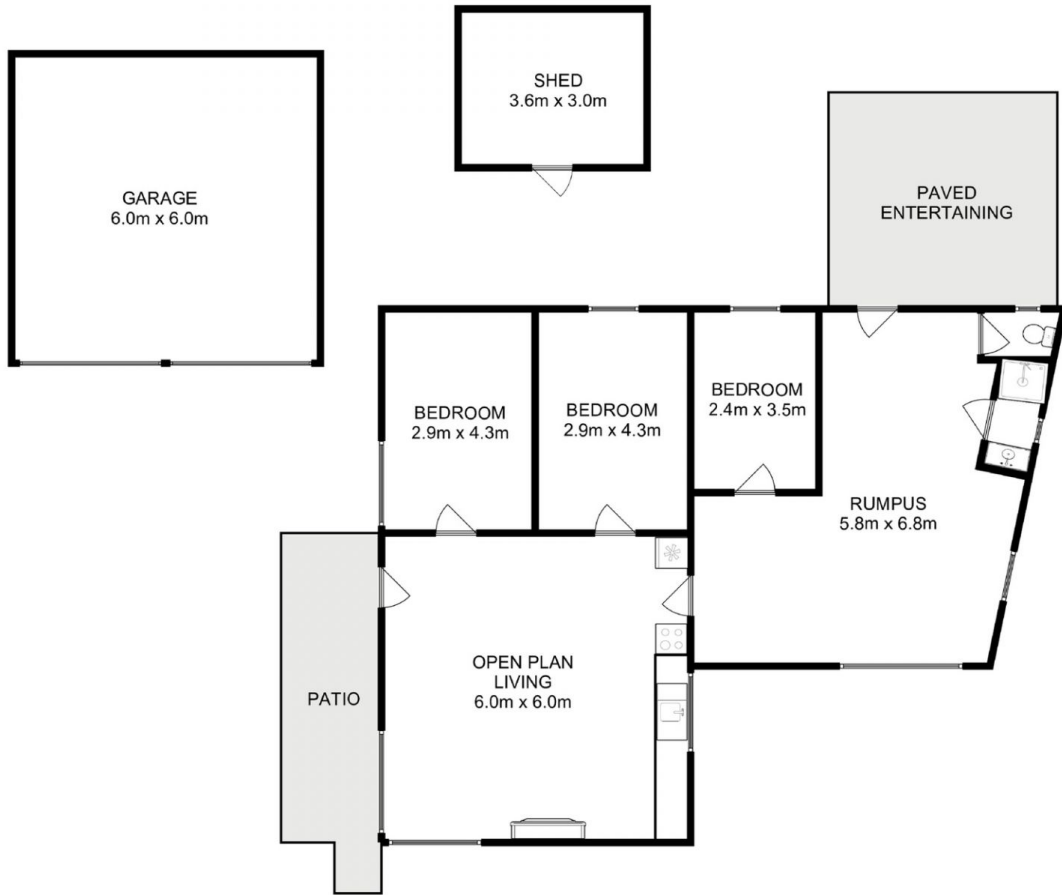

Total Approx. Floor Area : 116 sqm  
Total Approx. Outbuilding Area : 47 sqm

All measurements are internal and approximate.  
This plan is a sketch for illustration, not valuation.  
Produced by Open2view.com