



kate

reality



4 Black Jack Road Sloping Main TAS

5 🏠 2 🏠 7 🚗

Loads of Options. Stay in one and rent out the other! Approx \$400 -\$450 p/w for the main house and \$300 -\$350 p/w for the 2nd cottage. Escape to your dream coastal getaway at Sloping Main, nestled in the picturesque South-East of Tasmania. This exceptional real estate opportunity boasts two charming homes on a sprawling, generous block, perfect for creating lasting memories with friends and family during those cherished summer holidays. Situated in close proximity to the mesmerizing beach, you'll find yourself surrounded by coastal beauty and soothing water views. The first home, a delightful 3-bedroom retreat, offers ample space for relaxation and rejuvenation. Adjacent to it, the second 2-bedroom home welcomes you with a spacious deck, ideal for unwinding and soaking in the coastal ambiance.

Each home comes with its own fenced area, ensuring privacy and convenience for all. With plentiful parking and

Price : \$ 550,000
Building Size : 142 sqm
Land Size : 1265 sqm
View : <http://www.katestoreyrealty.com.au/sale/tas/hobart-southern/sloping-main/residential/house/7706362>



Kate Storey
03 6253 6095



Chloe Wright
(03) 6265 3000

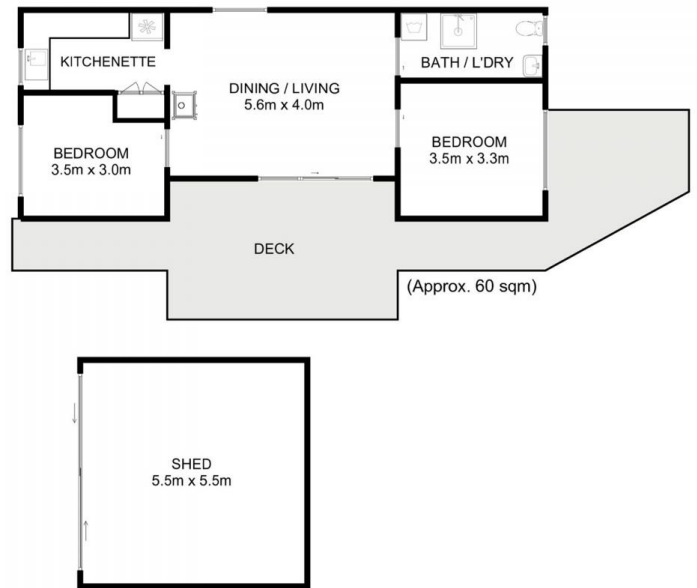
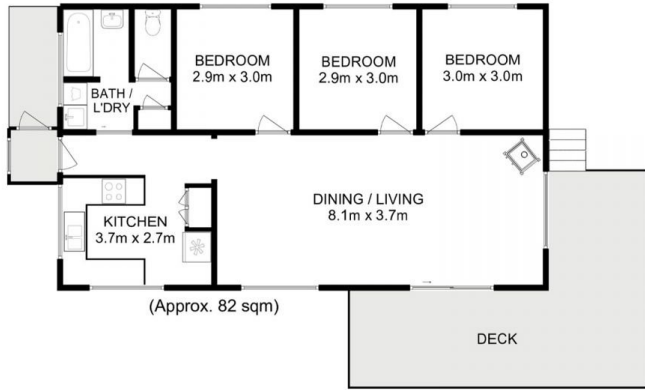

Total Approx. Floor Area : 142 sqm
 Total Approx. Outbuilding Area : 30 sqm

All measurements are internal and approximate.
 This plan is a sketch for illustration, not valuation.
 Produced by Open2view.com

