



kate

reality



415 Safety Cove Road Port Arthur TAS

4 🏠 3 🚗 9 🚗

This majestic view from the edge of the world is framed by the quintessential Australian gum trees, looking across the bay to Tasman Island and beyond. At low tide you can place your crayfish pots simply by walking across the lawn and down the stairs to the rock ledge. Watch the whales and dolphins go by from the shoreline or launch the boat for game fishing with the lure of a Southern Bluefin Tuna.

The architecturally designed home with floor to ceiling glass in the open plan living area has a forever changing atmospheric view. The interior is light, bright, and warm with the combination of gas heating and reverse cycle air-conditioning for temperature control of the entire home. The kitchen is spacious with a waterfall edge island bench and appliances worthy of a home of this caliber. There are multiple balconies and decks to capture the sun and views for a barbeque or sunset drink.

Building Size : 220 sqm
Land Size : 4318 sqm
View : <http://www.katestoreyrealty.com.au/sale/tas/hobart-southern/port-arthur/residential/house/7604173>



Kate Storey
03 6253 6095

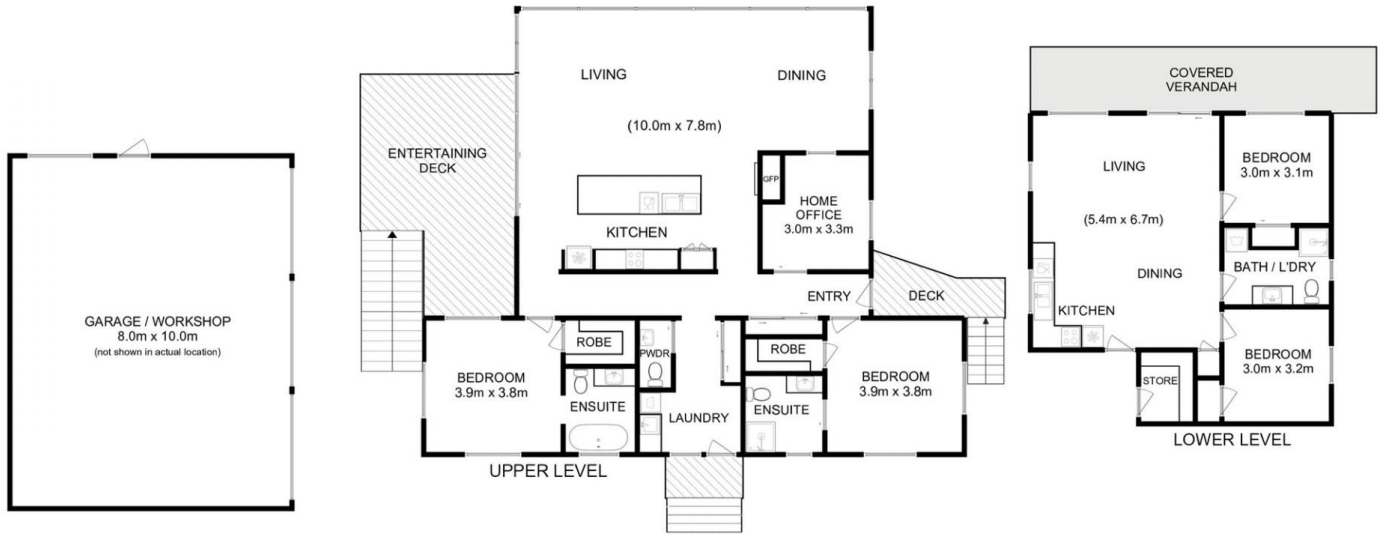

Total Approx. Floor Area : 220 sqm
 Total Approx. Outbuilding Area : 80 sqm



All measurements are internal and approximate.
 This plan is a sketch for illustration, not valuation.
 Produced by Open2view.com