





kate

reality



### 754 Primrose Sands Road Primrose Sands TAS

3  2  2 

Privately located towards the end of Primrose Sands Road this home is surrounded by Tasmanian native flora and fauna. With Susan's Bay beach just minutes from your property, spend your afternoons taking a relaxing stroll while admiring the ever-changing views.

Upon entering the home downstairs, the kitchen features solid timber bench tops, and a groovy green tiled splash-back. Continuing downstairs you will find two bedrooms and a combined bathroom and laundry. This property features a utility room with lift for internal access or there are external stairs.

Throughout the home the current owner has created memorable features with an assortment of timber such as myrtle, oak, and gum, creating a warm and inviting feel.

**Building Size** : 118 sqm  
**Land Size** : 556 sqm  
**View** : <http://www.katestoreyrealty.com.au/sale/tas/hobart-southern/primrose-sands/residential/house/7572082>



**Emily Collins**  
03 6265 3000

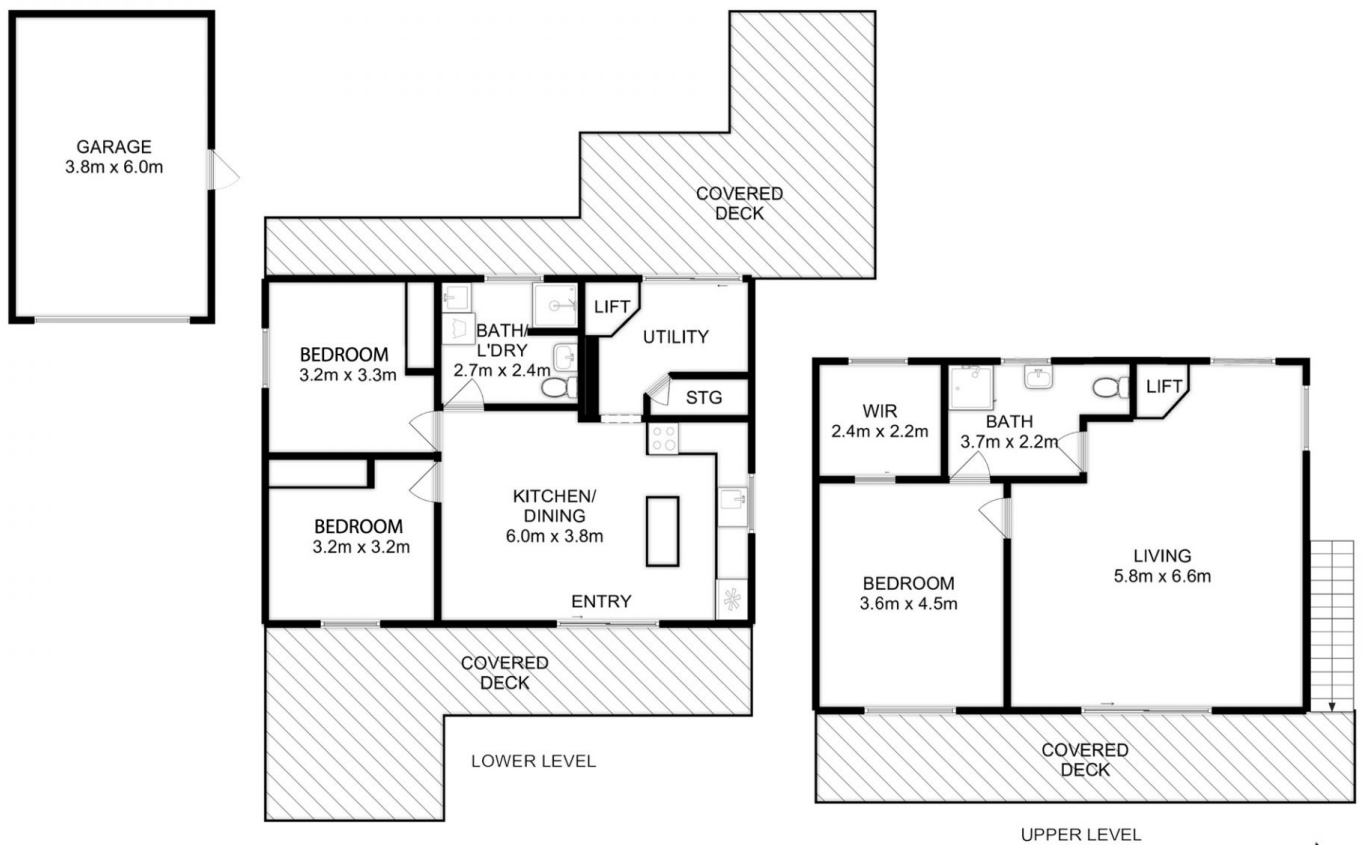

Total Approx. Floor Area : 134 sqm  
Total Approx. Outbuilding Area : 23 sqm

All measurements are internal and approximate.  
This plan is a sketch for illustration, not valuation.  
Produced by Open2view.com