



kate

reality



671 Kellevie Road Kellevie TAS

A perfect wilderness escape, this property allows the opportunity to leave all your troubles behind; approximately a 45-minute drive to Hobart. With a rustic one-bedroom studio, double garage and garden shed you will have the luxury of spontaneous getaways.

There are 2 new water tanks one is 14,000 litre and other is 10,000 litre with new electric pressure pump to supply studio. There is electric hot water with the option to use the solar hot water system in the warmer months. Surrounded by native flora and fauna, this easy-care retreat has its own vegie and fruit garden, supported by water from two dams.

Located near a popular mountain bike track, with beautiful Marion Bay Beach approximately 15 mins drive away, this property enjoys proximity to these and other impressive destinations like the Wielangta Forest (an Aboriginal name

Price : Vendor Says SELL!!! Offers Over \$538,000
Building Size : 45 sqm
Land Size : 13.58 ha
View : <http://www.katestoreyrealty.com.au/sale/tas/hobart-southern/kellevie/residential/and/6956679>



Kate Storey
03 6253 6095



Chloe Wright
(03) 6265 3000

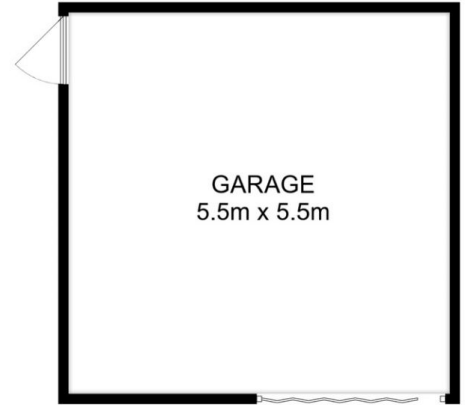
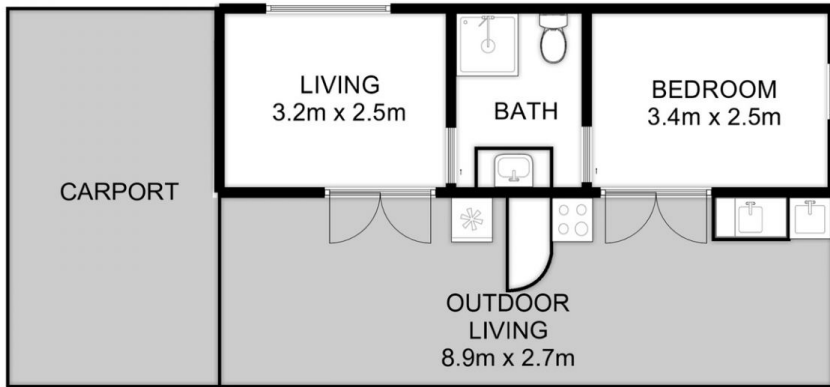
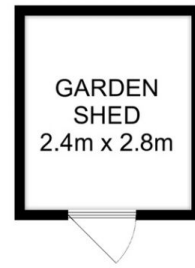

Total Approx. Floor Area : 25 sqm
 Total Approx. Outbuilding Area : 47 sqm

All measurements are internal and approximate.
 This plan is a sketch for illustration, not valuation.
 Produced by Open2view.com