



kate

reality



### 239 Lewisham Scenic Drive Lewisham TAS

3 2 2

Set along Lewisham's most prestigious address and enjoying a flat and level block, this home really captures what it is to live beside the sea and if there was ever a time to make a move to a coastal retreat it's now.

With direct access to the waterfront, separated by only coastal reserve, this 3 bedroom waterside home in the popular Southern Beaches suburb of Lewisham is sure to be a hit.

Waterfront living, we know is desired by many and why wouldn't it be? Coastal walks, swimming in the summer (and winter for the brave), fishing and a relaxed easy going lifestyle all at your door step, literally.

This 1950's brick beach house retains some of her original charm, while offering some modern convenience including

**Price** : \$ 901,000  
**Building Size** : 116 sqm  
**Land Size** : 607 sqm  
**View** : <http://www.katestoreyrealty.com.au/sale/tas/hobart-southern/lewisham/residential/house/6944910>



**Donna Wooley**  
03 6265 3000

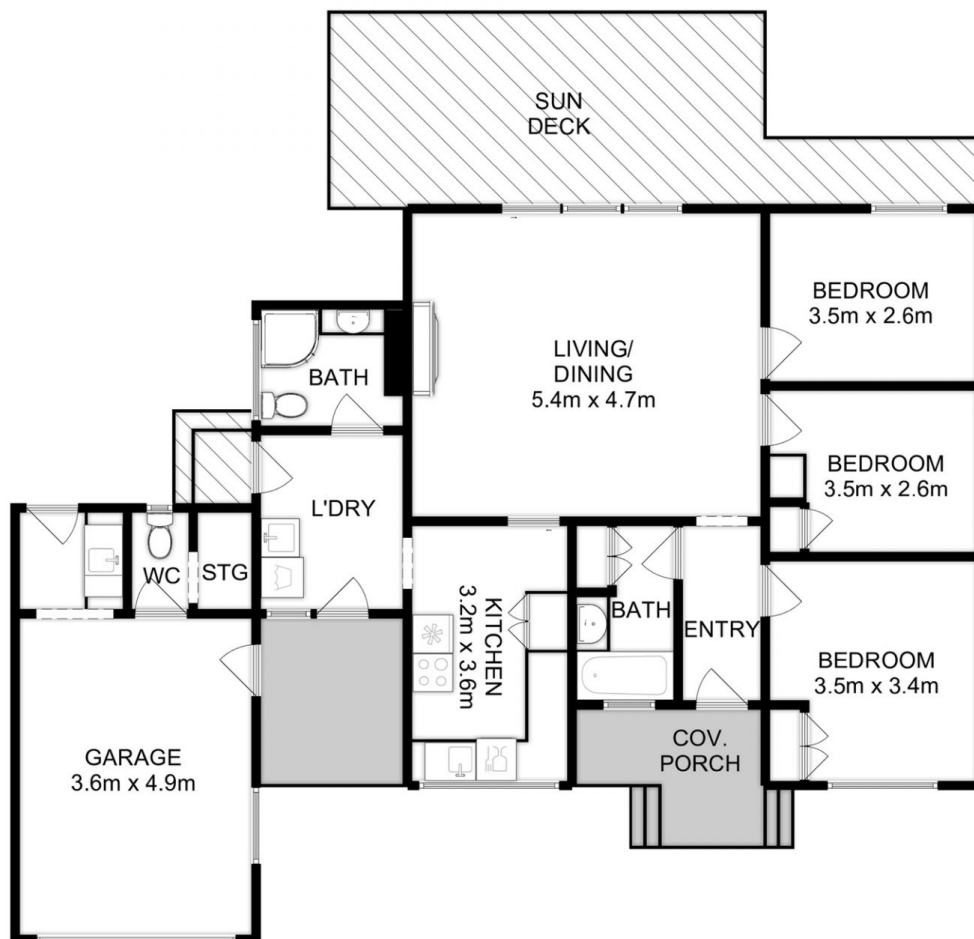

Total Approx. Floor Area (inc. garage) : 116 sqm

All measurements are internal and approximate.  
This plan is a sketch for illustration, not valuation.  
Produced by Open2view.com