



kate

reality



28 Talone Road Blackmans Bay TAS

4 2 4

This large family home, with 4 bedrooms has been tastefully updated by its current owners, with a complete transformation on the lower level.

By opening up the space, you are welcomed by an abundance of natural light, flooding through from the back wall of double-glazed windows and doors.

There are clever bi-fold doors off the breakfast bar that open up to a servery on the other side, perfect for indoor/outdoor entertaining.

The kitchen is well proportioned with a walk-in pantry, 90cm oven and induction cooktop.

The open plan space allows for easy family living and the bonus of a separate living/sitting room provides a quiet

Building Size : 182 sqm
Land Size : 992 sqm
View : <http://www.katestoreyrealty.com.au/sale/tas/hobart-southern/blackmans-bay/residential/house/6656123>



Donna Wooley
03 6265 3000



Emily Collins
03 6265 3000

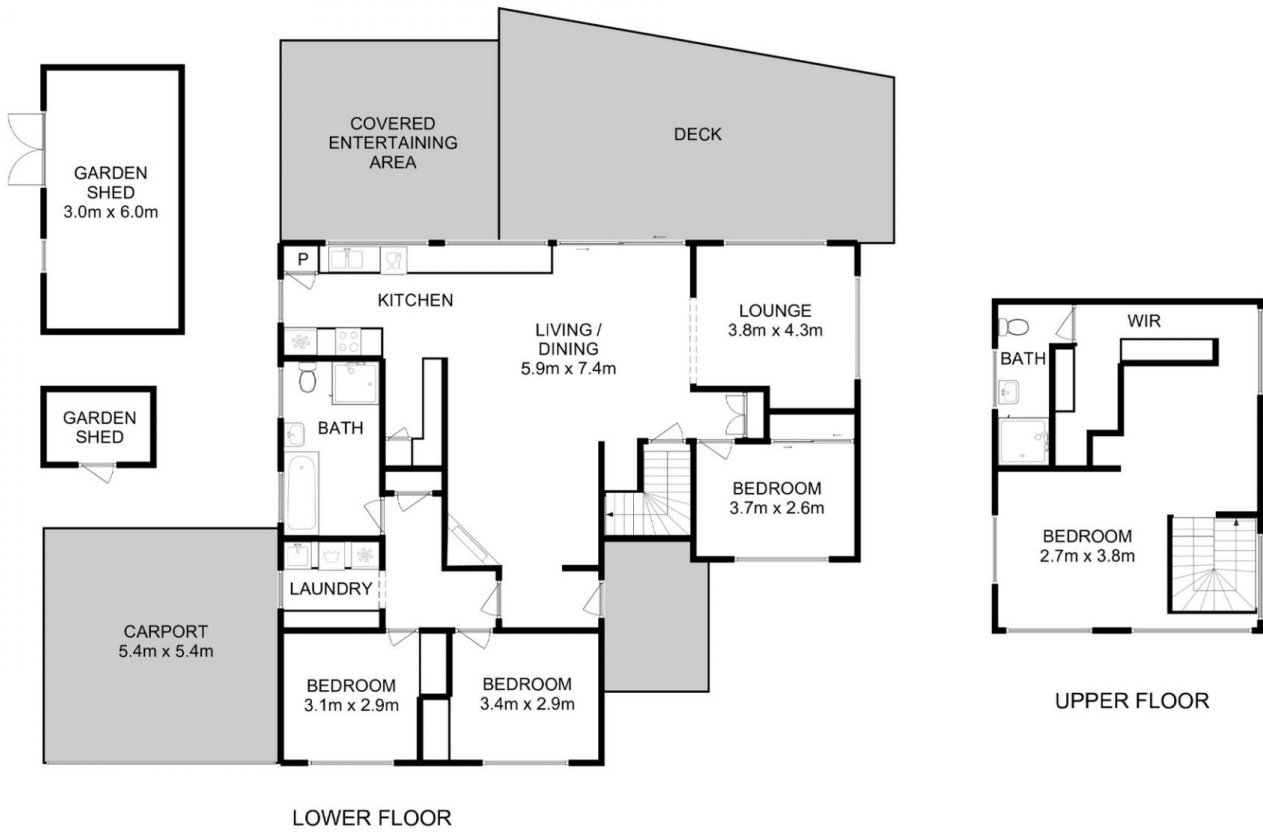

All measurements are internal and approximate.
 This plan is a sketch for illustration, not valuation.
 Produced by Open2view.com.

Approx. house area: 185 sqm
 Approx. outbuilding area: 22 sqm

